

# Ballistic Rated Door Viewers



- For internal & external applications
- Extensive range of testing
- Can be adjusted to suit varying door & panel thicknesses with extension pieces & spacers available
- Satin stainless steel finish as standard  
- other finishes available on request
- Fire rated to 60 minutes

## Testing Certification Available

	Single Shot Tests	EN 1063	NIJ 0108.01	UL 752
Handgun	.357 Magnum	BR3	Level II	Level 2
Handgun	.44 Magnum	BR4	Level IIIA	Level 3
Rifle	5.56 x 45 NATO	BR5	NA	Level 7
Rifle	7.62 x 51 NATO	BR6	Level III	Level 5
Rifle	7.62 x 51 AP	BR7	Level IV	Level 9
Shotgun	Solid slug	SG1	NA	

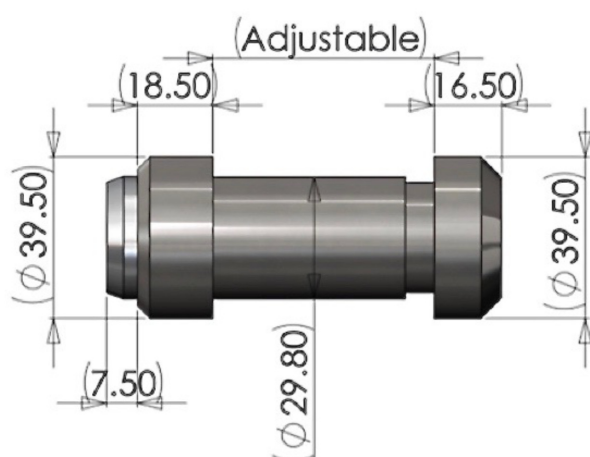

Standard Viewer

The door viewer has a body diameter of 29.8mm, requiring a 30mm hole.

## Easy Installation

- Insert outer body (female thread) from attack side
- Apply thread lock (not supplied)
- Insert inner body (male thread) from secure side
- Screw parts together
- Hand tighten



# Architectural Armour

For our full range of Bullet, Blast & Attack Resistant Windows Walls and Doors contact  
**+44(0)1981 257000    sales@architecturalarmour.com    www.architecturalarmour.com**

# Ballistic Rated Door Viewers



## Standard Viewer

- Min door leaf / panel 49mm thick
- Thinner constructions of doors / panels can be accommodated with a spacer



- Max door leaf / panel 60mm thick
- Thicker constructions of doors / panels can be accommodated with an extension piece or custom body



## Spacer

Spacers can be used to accommodate thinner door leafs / panels.  
This example is 24mm thick

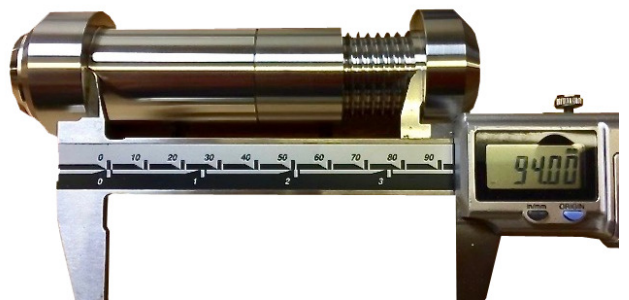

## Extension Pieces

Extension pieces can be used to accommodate thicker door leafs / panels up to 94mm



# Architectural Armour

For our full range of Bullet, Blast & Attack Resistant Windows Walls and Doors contact  
**+44(0)1981 257000**    **sales@architecturalarmour.com**    **www.architecturalarmour.com**